

# (bedcolab)

Forte laboratory casework system



# Forte Casework System

Setting the standards for strength  
and durability... by design.



Welcome to the Bedcolab **Forte** casework catalogue. The **Forte** is our conventional floor mounted casework system. It features a sturdy 18 gauge steel construction designed to meet or exceed the rigorous standard *SEFA-B 1999*, of the *Scientific equipment and Furniture Association*.

Because we know that labs sometimes need to adapt to the changing needs of the research, the Forte cabinet has been designed using 3-D engineering software to allow for easy cabinet re-configuration even after it has been installed. With simple hand tools, the user can easily remove doors and drawers and relocated them to personalize his or her space.

For that special designer look, **Forte** cabinets are also available with either insert or flush overlay color coordinated wood or plastic laminate door and drawer fronts.



Designed to last... built to last even longer.

# Using this catalog

## Reading the product identification numbers

The **Bedcolab** product identification number is simple, making it easy to verify that you have ordered the correct cabinet. Each number or letter in the designation represents an aspect of the cabinet. Below are examples of the product identification numbers you will see in this catalog along with an explanation of each designation:

### Product identification code

	<b>A</b>	<b>6A</b>	<b>30</b>	<b>5</b>	
<b>Cabinet height</b>					<b>Quantity of drawers</b>
<ul style="list-style-type: none"> <li>• A – standing</li> <li>• B – sitting</li> </ul>					1 – 16
<b>Cabinet style</b>					<b>Cabinet width</b>
<ul style="list-style-type: none"> <li>• Drawered cabinet</li> <li>• Doored cabinet</li> <li>• Combination door/drawer</li> <li>• Mixed combination door/drawer</li> </ul>			15 in.	30 in.	
			18 in.	36 in.	
			21 in.	42 in.	
			24 in.	48 in.	

### Base cabinets

	<b>A</b>	<b>15</b>	<b>24</b>	<b>“REV”</b>	
<b>Cabinet height</b>					<b>Cabinet door opens to right</b>
<ul style="list-style-type: none"> <li>• A – standing</li> <li>• B – sitting</li> </ul>					
<b>Cabinet style</b>					<b>Cabinet width</b>
<ul style="list-style-type: none"> <li>• Drawered cabinet</li> <li>• Doored cabinet</li> <li>• Combination door/drawer</li> <li>• Mixed combination door/drawer</li> </ul>			15 in.	30 in.	
			18 in.	36 in.	
			21 in.	42 in.	
			24 in.	48 in.	

### Base cabinets

	<b>75</b>	<b>42</b>	<b>18</b>		
				<b>Cabinet depth</b>	
				14, 18, 22	
<b>Cabinet style</b>					<b>Cabinet width</b>
<ul style="list-style-type: none"> <li>• Single door</li> <li>• Double door</li> <li>• Glass door</li> <li>• Glazed door</li> </ul>			15 in.	30 in.	
			18 in.	36 in.	
			21 in.	42 in.	
			24 in.	48 in.	

### Wall and floor cases

## Understanding the alphanumeric index

For quick reference you will find an alphanumeric index of the product identification numbers at the rear of the catalog. Identifying the product in this index will lead you to the page on which the cabinet is found. It is quick and helpful for placing orders.

## Placing an order

Placing an order for **Bedcolab** furniture is easy. Just remember the following steps:

1. Choose the correct product identification number – Refer to the alphanumeric index at the end of the catalog and cross check it with the three dimensional drawing on the corresponding page. You will also find the cabinet dimensions.
2. Indicate your choice of options – Be sure to identify which options need to be included in your order. These are the main ones to identify, special orders should be noted.
  - a. drawer slide arms
    - self-closing (standard)
    - full extension
  - b. hinges
    - black
    - stainless steel
  - c. door and drawer pulls
    - recessed black PVC
    - recessed brushed aluminum
    - 4” stainless steel wire pulls
  - d. locks and keying system
  - e. fillers and gables
3. Select the colours and finishes – Both liquid and powder coat paint finishes are available in a wide range of colours. Indicate your choice for the cabinet body as well as the door and drawer fronts.
4. Choose your fixtures and accessories – From the accessories catalog pick out the appropriate sinks, electrical service fittings, mechanical service fittings and pipe supports. *[Our project managers are always available for consulting.]*
5. Decide on a work surface – The work surface material needs to be selected as well as the colour and finish. Refer to the accessories catalog.

*Remember, should you require any assistance, we are only a phone call away and our project managers will be pleased to help.*

## Cabinet construction details

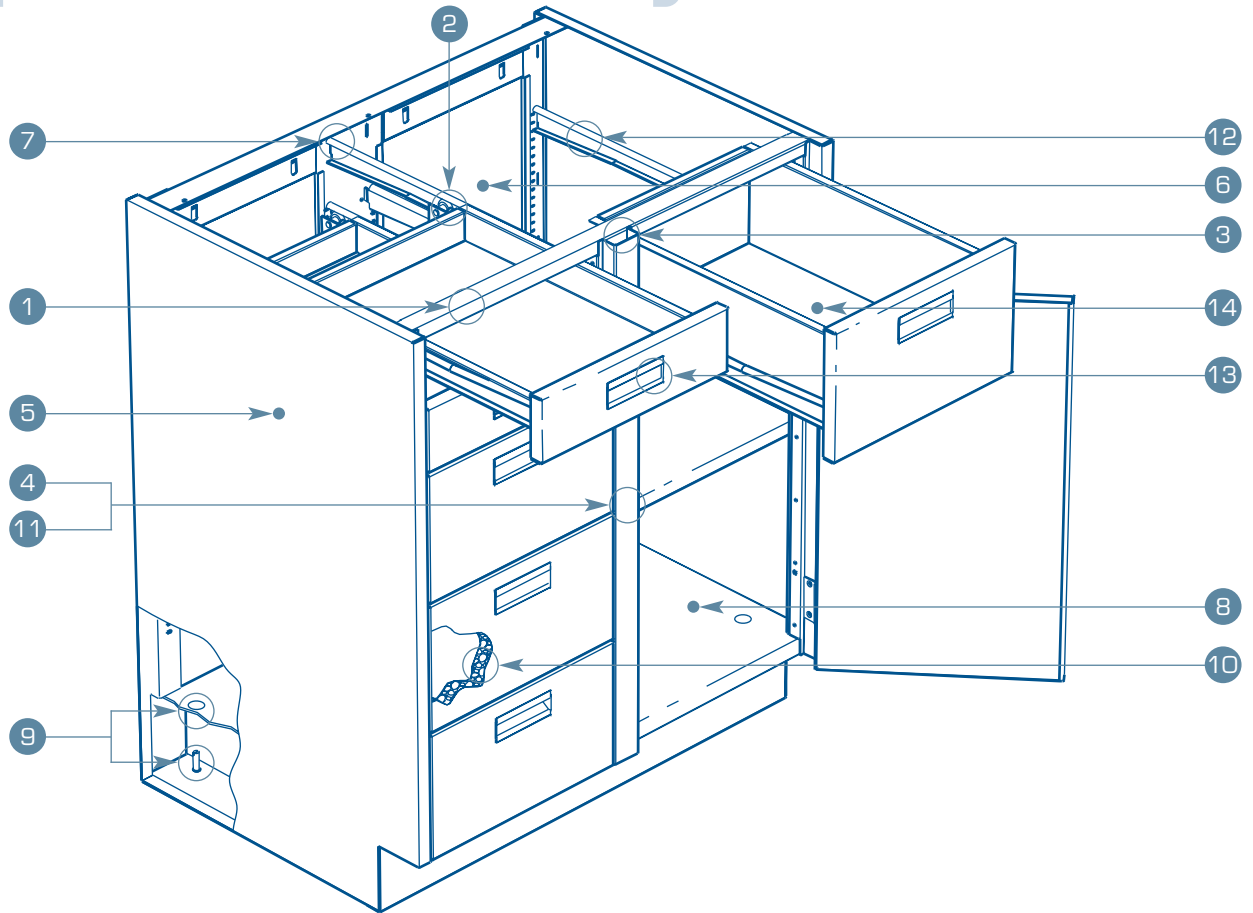

Feature	Benefit
1 An intermediate front horizontal rail.	Dust protection, additional rigidity.
2 The slide arms have ball bearing rollers.	Long-lasting, smooth operation.
3 A removable front center post.	Full flexibility for all door and drawer arrangements.
4 The front post can accommodate varying arrangements of doors & drawers.	Flexibility even after installation.
5 A wrap around cabinet body construction: sides, back and outside cornerposts are made from one sheet of 18 gauge steel.	Provides maximum strength and eliminates need for an applied finished back.
6 A removable back panel on all cupboard areas.	Permits accessibility to services.
7 A slotted rear center post.	Support for slide arms and shelves. Full flexibility for future needs.
8 The cabinet body is fully-enclosed and easy to clean.	Easier maintenance and cleaning.
9 The 5/16" threaded leveller has a nylon glide cap.	Solid, sturdy and prevents scratching or marking the floor.
10 The doors and drawers have sound absorbing material.	Keeps noise to a minimum when opening and closing.
11 There are no center posts on double doors.	Offers full opening of cabinets for easy access.
12 The self-closing slide arms are standard.	Drawers remain closed, avoiding accidents or spills.
13 The choice of recessed black PVC, recessed brushed aluminum or 4" stainless steel wire pulls.	Get the right look for your lab.
14 The drawers are made extra deep.	Additional storage capacity.

# Standing height base cabinets

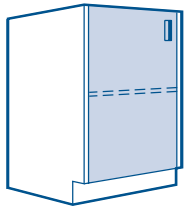

Model no.	Width	
	inches	mm
A1-15	15	381
A1-18	18	457
A1-21	21	533
A1-24	24	610

**1 door unit**

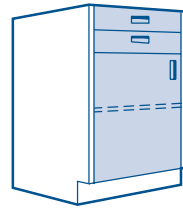

A4-15-2	15	381
A4-18-2	18	457
A4-21-2	21	533
A4-24-2	24	610

**2 drawer - 1 door unit**

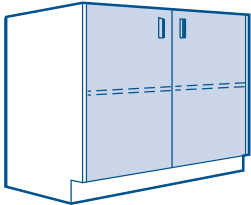

A2-30	30	762
A2-36	36	914
A2-42	42	1067
A2-48	48	1219

**2 door unit**

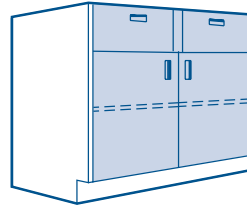

A5-30-2	30	762
A5-36-2	36	914
A5-42-2	42	1067
A5-48-2	48	1219

**2 drawer - 2 door unit**

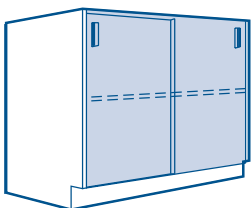

A3-30	30	762
A3-36	36	914
A3-42	42	1067
A3-48	48	1219

**2 sliding door unit**

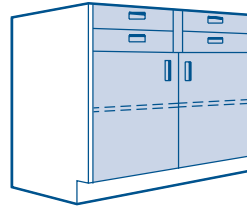

A5-30-4	30	762
A5-36-4	36	914
A5-42-4	42	1067
A5-48-4	48	1219

**4 drawer - 2 door unit**

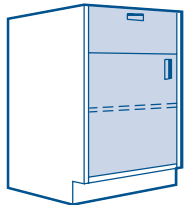

A4-15-1	15	381
A4-18-1	18	457
A4-21-1	21	533
A4-24-1	24	610

**1 drawer - 1 door unit**

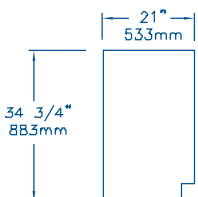

Reverse models are also available as a standard cabinet by adding "REV" to model number.

# Standing height base cabinets

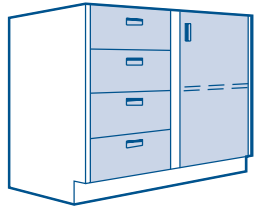

Model no.	Width	
	inches	mm
A6-30-4	30	762
A6-36-4	36	914
A6-42-4	42	1067
A6-48-4	48	1219

**4 drawer - 1 door unit**

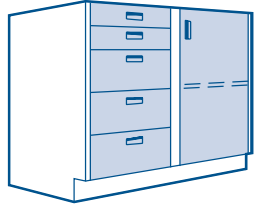

A6-30-5	30	762
A6-36-5	36	914
A6-42-5	42	1067
A6-48-5	48	1219

**5 drawer - 1 door unit**

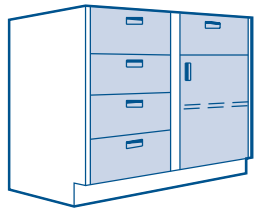

A6A-30-5	30	762
A6A-36-5	36	914
A6A-42-5	42	1067
A6A-48-5	48	1219

**5 drawer - 1 door unit**

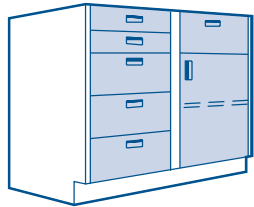

A6A-30-6	30	762
A6A-36-6	36	914
A6A-42-6	42	1067
A6A-48-6	48	1219

**6 drawer - 1 door unit**

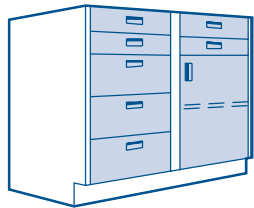

A6A-30-7	30	762
A6A-36-7	36	914
A6A-42-7	42	1067
A6A-48-7	48	1219

**7 drawer - 1 door unit**

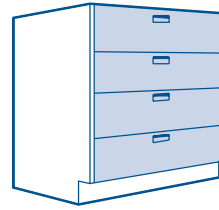

A7-15-4	15	381
A7-18-4	18	457
A7-21-4	21	533
A7-24-4	24	610
A7-30-4	30	762
A7-36-4	36	914
A7-42-4	42	1067
A7-48-4	48	1219

**4 drawer unit\***

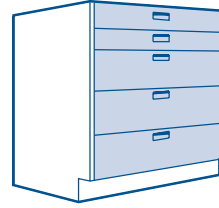

A7-15-5	15	381
A7-18-5	18	457
A7-21-5	21	533
A7-24-5	24	610
A7-30-5	30	762
A7-36-5	36	914
A7-42-5	42	1067
A7-48-5	48	1219

**5 drawer unit\***

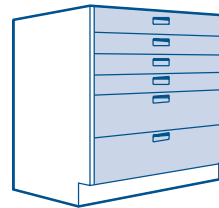

A7-15-6	15	381
A7-18-6	18	457
A7-21-6	21	533
A7-24-6	24	610
A7-30-6	30	762
A7-36-6	36	914
A7-42-6	42	1067
A7-48-6	48	1219

**6 drawer unit\***

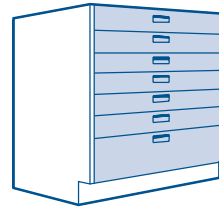

A7-15-7	15	381
A7-18-7	18	457
A7-21-7	21	533
A7-24-7	24	610
A7-30-7	30	762
A7-36-7	36	914
A7-42-7	42	1067
A7-48-7	48	1219

**7 drawer unit\***

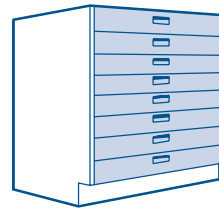

A7-15-8	15	381
A7-18-8	18	457
A7-21-8	21	533
A7-24-8	24	610
A7-30-8	30	762
A7-36-8	36	914
A7-42-8	42	1067
A7-48-8	48	1219

**8 drawer unit\***

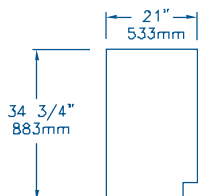

\* Double pulls on 30" to 48" models.

Reverse models are also available as a standard cabinet by adding "REV" to model number.

# Standing height base cabinets

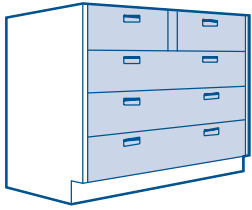

Model no.	Width	
	inches	mm
A8-30-5	30	762
A8-36-5	36	914
A8-42-5	42	1067
A8-48-5	48	1219

**5 drawer unit**

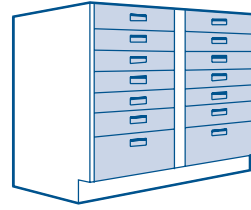

A10-30-14	30	762
A10-36-14	36	914
A10-42-14	42	1067
A10-48-14	48	1219

**14 drawer unit**

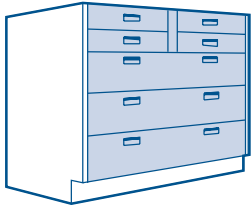

A8-30-7	30	762
A8-36-7	36	914
A8-42-7	42	1067
A8-48-7	48	1219

**7 drawer unit**

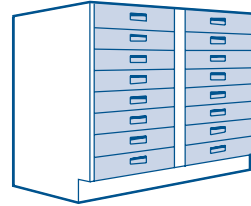

A10-30-16	30	762
A10-36-16	36	914
A10-42-16	42	1067
A10-48-16	48	1219

**16 drawer unit**

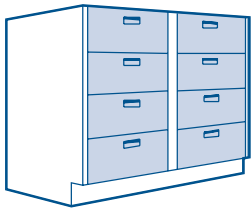

A10-30-8	30	762
A10-36-8	36	914
A10-42-8	42	1067
A10-48-8	48	1219

**8 drawer unit**

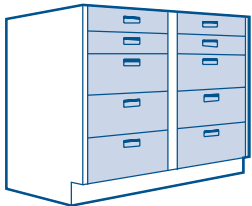

A10-30-10	30	762
A10-36-10	36	914
A10-42-10	42	1067
A10-48-10	48	1219

**10 drawer unit**

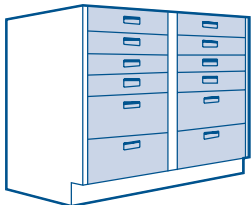

A10-30-12	30	762
A10-36-12	36	914
A10-42-12	42	1067
A10-48-12	48	1219

**12 drawer unit**

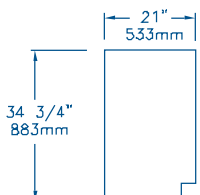

# Standing height base cabinets

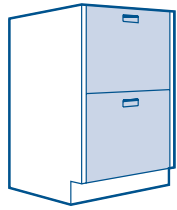

Model no.	Width	
	inches	mm
A11-15-2	15	381
A11-18-2	18	457
A11-21-2	21	533
A11-24-2	24	610

**2 file drawer unit\***

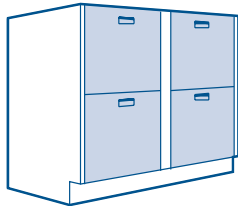

A11-30-4	30	762
A11-36-4	36	914
A11-42-4	42	1067
A11-48-4	48	1219

**4 file drawer unit\***

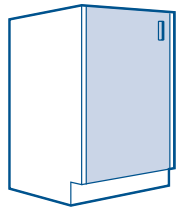

A15-15	15	381
A15-18	18	457
A15-21	21	533
A15-24	24	610

**1 door sink unit\*\***

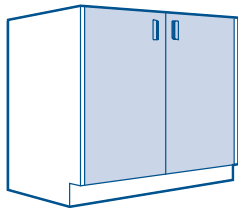

A16-30	30	762
A16-36	36	914
A16-42	42	1067
A16-48	48	1219

**2 door sink unit\*\***

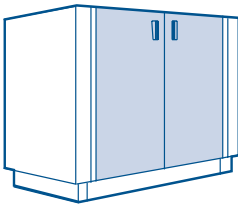

A17-52	52	1321
A17-58	58	1473

**Island end sink unit**

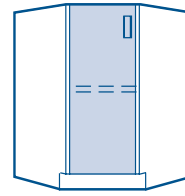

A18-31	31	787
--------	----	-----

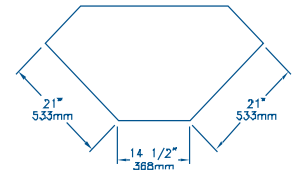

**45° corner unit**

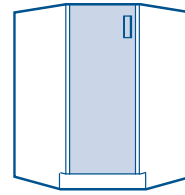

A18S-31	31	787
---------	----	-----

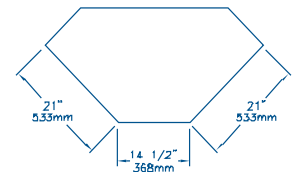

**45° corner sink unit\*\***

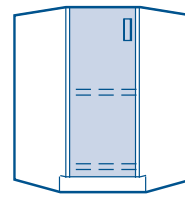

A19-31	31	787
--------	----	-----

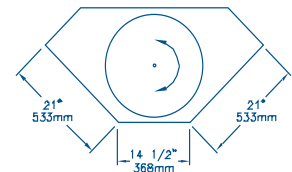

**45° corner unit with lazy susan**

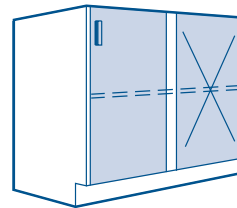

A20-30	30	762
A20-36	36	914
A20-42	42	1067
A20-48	48	1219

**Corner unit**

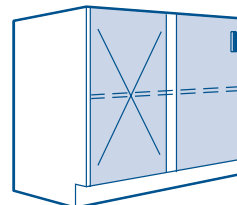

A21-30	30	762
A21-36	36	914
A21-42	42	1067
A21-48	48	1219

**Corner unit**

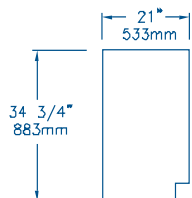

\* Legal or letter size file drawers with hanger bars and full extension slide arms.

\*\* Back panel is 9" in height (229 mm). Stainless steel waste chute and waste basket are available by adding "WVC" and "WB" to model number.

Reverse models are also available as a standard cabinet by adding "REV" to model number.



# Standing height base cabinets

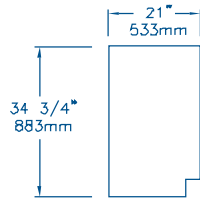
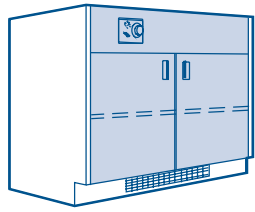

**Glassware drying unit**

Model no.	Width	
	inches	mm
A22-36	36	914
A22-48	48	1219

**Description**

- Glassware drying units are equipped with electrical heating elements maximum temperature 185° F (85° C) 115V-15A.
- Unit is equipped with an on/off switch, pilot light, and thermostatic temperature control, all pre-wired to a junction box mounted at the rear of unit.
- Unit is lined with 1/4" (6 mm) chemical resistant liner material.
- Each unit has a stainless steel perforated adjustable shelf.

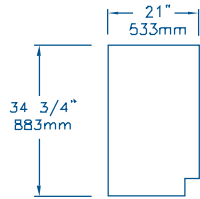
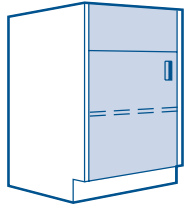

**1 door remote control unit**

A24-18	18	457
A24-24	24	610

- Fixed upper panel for mounting of services.
- This unit is mostly used under fume hoods where services are deck mounted.

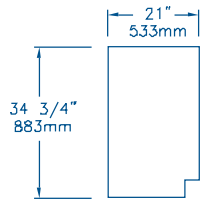
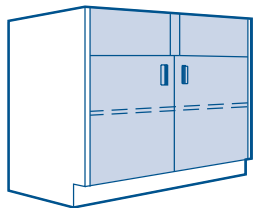

**2 door remote control unit**

A24-30	30	762
A24-36	36	914
A24-48	48	1219

- Fixed upper panel for mounting of services.
- This unit is mostly used under fume hoods where services are deck mounted.

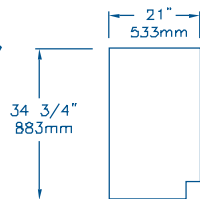
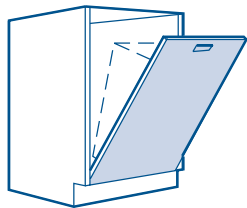

**1 door bin unit**

A28-18	18	457
A28-24	24	610

- Bins are not included.
- Bins can be supplied by adding the following letters after catalog number:
  - "GB" for galvanized steel;
  - "SSB" for stainless steel type 304;
  - For leak proof bin add the letters "LP".

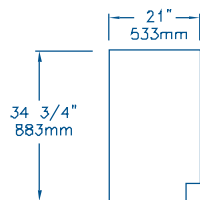
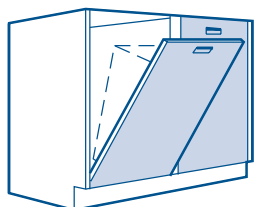

**2 door bin unit**

A29-36	36	914
A29-48	48	1219

- Bins are not included.
- Bins can be supplied by adding the following letters after catalog number:
  - "GB" for galvanized steel;
  - "SSB" for stainless steel type 304;
  - For leak proof bin add the letters "LP".

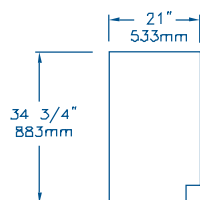
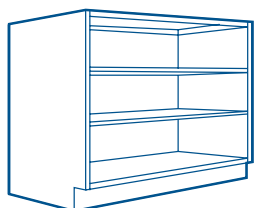

**Open rack unit**

A35-15	15	381
A35-18	18	457
A35-21	21	533
A35-24	24	610
A35-30	30	762
A35-36	36	914
A35-42	42	1067
A35-48	48	1219

- Two (2) adjustable shelves.

Reverse models are also available as a standard cabinet by adding "REV" to model number.

# Flammable and acid storage cabinets

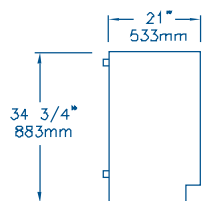
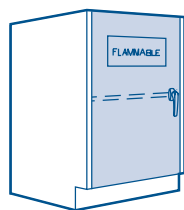

Model no.	Width	
	inches	mm
A23-18	18	457
A23-24	24	610

## Description

- Solvent storage units meet O.S.H.A. standards and comply with N.F.P.A. code no. 30 for flammable and combustible liquids.
- Two fire baffle vents are located in back of unit.
- Door is hinged with a continuous stainless steel hinge.
- Recessed base to match standard base cabinets.
- One adjustable shelf, two point locking handle, standard colour safety yellow.
- Bilingual safety label available.
- UL certified.

### Under counter flammable solvent storage unit

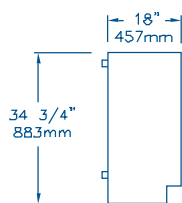
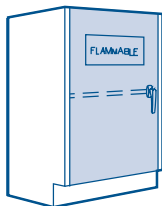

A23-18-18	18	457
A23-24-18	24	610

- Same as model no. A23 above except 18" (457 mm) deep.
- This unit to be used under fume hoods with a 6" (152 mm) diameter cupsink.

### Under counter flammable solvent storage unit

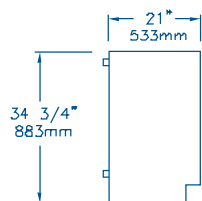
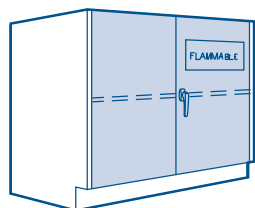

A23-30	30	762
A23-36	36	914
A23-48	48	1219

- Solvent storage units meet O.S.H.A. standards and comply with N.F.P.A. code no. 30 for flammable and combustible liquids.
- Two fire baffle vents are located in back of unit.
- This unit has a bi-fold door with a fusible link.
- Recessed base to match standard base cabinets.
- One adjustable shelf, two point locking handle, standard colour safety yellow.
- Bilingual safety label available.
- UL certified.

### Under counter flammable solvent storage unit

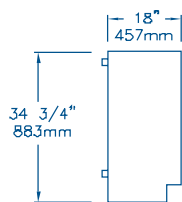
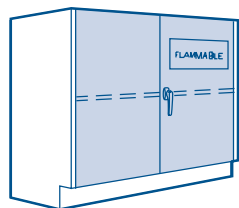

A23-30-18	30	762
A23-36-18	36	914
A23-48-18	48	1219

- Same as model no. A23 above except 18" (457 mm) deep.
- This unit to be used under fume hoods with a 6" (152 mm) diameter cupsink.

### Under counter flammable solvent storage unit

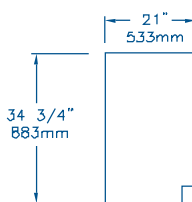
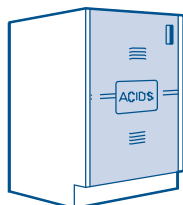

A25-18	18	457
A25-24	24	610

- Unit is lined with 1/4" (6 mm) chemical resistant liner material.
- Each unit has a stainless steel perforated adjustable shelf.
- Bilingual safety label available.
- Unit can be vented into fume hood by adding "V" after model number.

### Acid storage unit

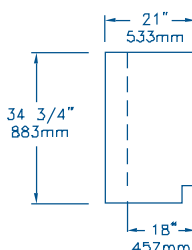
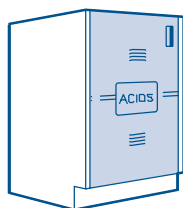

A25-18-18	18	457
A25-24-18	24	610

- Same as model no. A25 above except 18" (457 mm) deep.
- This unit to be used under fume hoods with a 6" (152 mm) diameter cupsink.

### Acid storage unit

Reverse models are also available as a standard cabinet by adding "REV" to model number.

# Flammable and acid storage cabinets

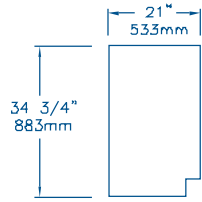
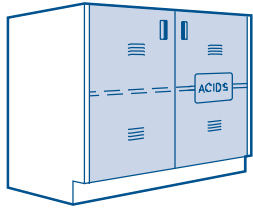

**Acid storage unit**

Model no.	Width	
	inches	mm
A25-30	30	762
A25-36	36	914
A25-48	48	1219

**Description**

- Unit is lined with 1/4" (6 mm) chemical resistant liner material.
- Each unit has a stainless steel perforated adjustable shelf.
- Bilingual safety label available.
- Unit can be vented into fume hood by adding "V" after model number.

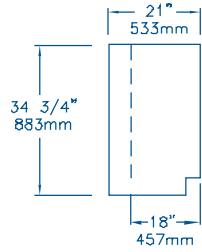
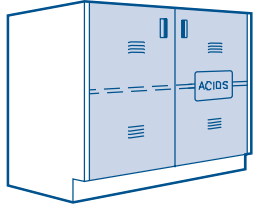

**Acid storage unit**

A25-30-18	30	762
A25-36-18	36	914
A25-48-18	48	1219

- Same as model no. A25 above except 18" (457 mm) deep.
- This unit to be used under fume hoods with a 6" (152 mm) diameter cupsink.

# Sitting height base cabinets

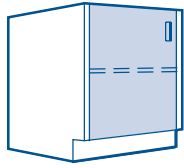

Model no.	Width	
	inches	mm
B1-15	15	381
B1-18	18	457
B1-21	21	533
B1-24	24	610

## 1 door unit

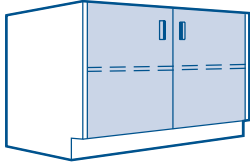

B2-30	30	762
B2-36	36	914
B2-42	42	1067
B2-48	48	1219

## 2 door unit

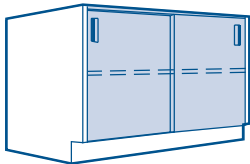

B3-30	30	762
B3-36	36	914
B3-42	42	1067
B3-48	48	1219

## 2 sliding door unit

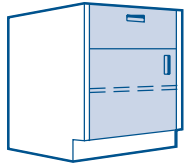

B4-15-1	15	381
B4-18-1	18	457
B4-21-1	21	533
B4-24-1	24	610

## 1 drawer - 1 door unit

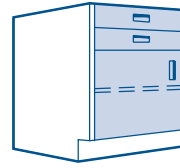

B4-15-2	15	381
B4-18-2	18	457
B4-21-2	21	533
B4-24-2	24	610

## 2 drawer - 1 door unit

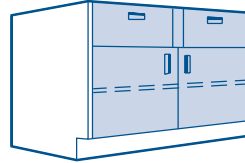

B5-30-2	30	762
B5-36-2	36	914
B5-42-2	42	1067
B5-48-2	48	1219

## 2 drawer - 2 door unit



B5-30-4	30	762
B5-36-4	36	914
B5-42-4	42	1067
B5-48-4	48	1219

## 4 drawer - 2 door unit

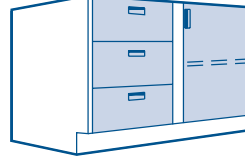

B6-30-3	30	762
B6-36-3	36	914
B6-42-3	42	1067
B6-48-3	48	1219

## 3 drawer - 1 door unit

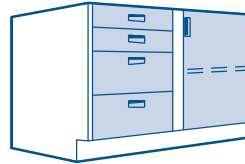

B6-30-4	30	762
B6-36-4	36	914
B6-42-4	42	1067
B6-48-4	48	1219

## 4 drawer - 1 door unit

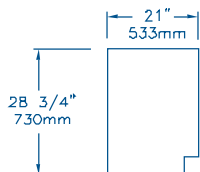

Reverse models are also available as a standard cabinet by adding "REV" to model number.

# Sitting height base cabinets

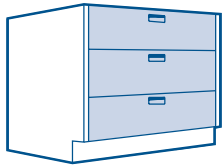

Model no.	Width	
	inches	mm
B7-15-3	15	381
B7-18-3	18	457
B7-21-3	21	533
B7-24-3	24	610
B7-30-3	30	762
B7-36-3	36	914
B7-42-3	42	1067
B7-48-3	48	1219

**3 drawer unit\***

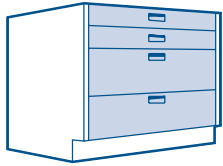

B7-15-4	15	381
B7-18-4	18	457
B7-21-4	21	533
B7-24-4	24	610
B7-30-4	30	762
B7-36-4	36	914
B7-42-4	42	1067
B7-48-4	48	1219

**4 drawer unit\***

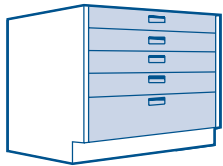

B7-15-5	15	381
B7-18-5	18	457
B7-21-5	21	533
B7-24-5	24	610
B7-30-5	30	762
B7-36-5	36	914
B7-42-5	42	1067
B7-48-5	48	1219

**5 drawer unit\***

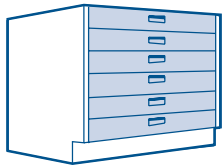

B7-15-6	15	381
B7-18-6	18	457
B7-21-6	21	533
B7-24-6	24	610
B7-30-6	30	762
B7-36-6	36	914
B7-42-6	42	1067
B7-48-6	48	1219

**6 drawer unit\***

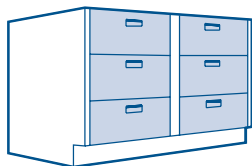

B10-30-6	30	762
B10-36-6	36	914
B10-42-6	42	1067
B10-48-6	48	1219

**6 drawer unit**

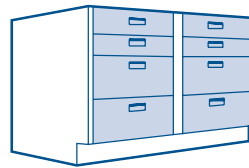

B10-30-8	30	762
B10-36-8	36	914
B10-42-8	42	1067
B10-48-8	48	1219

**8 drawer unit**



B10-30-10	30	762
B10-36-10	36	914
B10-42-10	42	1067
B10-48-10	48	1219

**10 drawer unit**



B10-30-12	30	762
B10-36-12	36	914
B10-42-12	42	1067
B10-48-12	48	1219

**12 drawer unit**

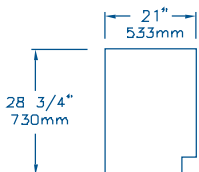

\* Double pulls on 30" to 48" models.

# Sitting height base cabinets

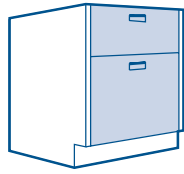

Model no.	Width	
	inches	mm
B11-15-2	15	381
B11-18-2	18	457
B11-21-2	21	533
B11-24-2	24	610

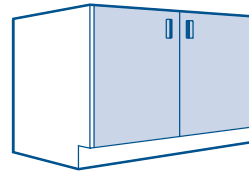

B16-30	30	762
B16-36	36	914
B16-42	42	1067
B16-48	48	1219

## File drawer unit\*

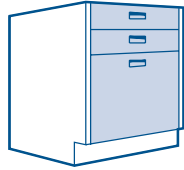

B11-15-3	15	381
B11-18-3	18	457
B11-21-3	21	533
B11-24-3	24	610

## 2 door sink unit\*\*

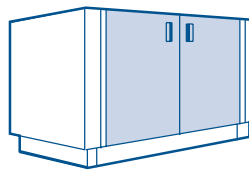

B17-52	52	1321
B17-58	58	1473

## File drawer unit\*

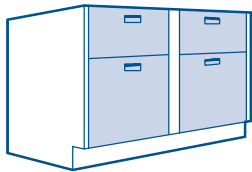

B11-30-4	30	762
B11-36-4	36	914
B11-42-4	42	1067
B11-48-4	48	1219

## Island end sink unit

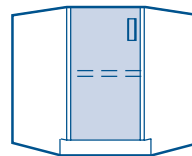

B18-31	31	787
--------	----	-----

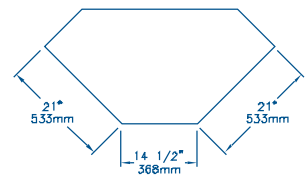

## File drawer unit\*

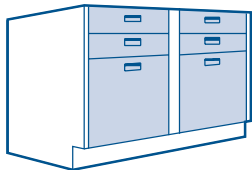

B11-30-6	30	762
B11-36-6	36	914
B11-42-6	42	1067
B11-48-6	48	1219

## 45° corner unit

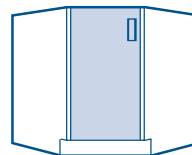

B18S-31	31	787
---------	----	-----

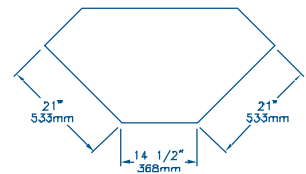

## File drawer unit\*

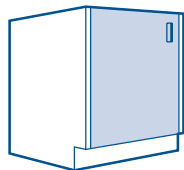

B15-15	15	381
B15-18	18	457
B15-21	21	533
B15-24	24	610

## 45° corner sink unit\*\*

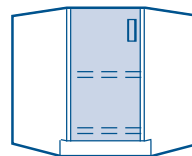

B19-31	31	787
--------	----	-----

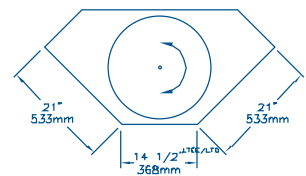

## 1 door sink unit\*\*

## 45° corner unit with lazy susan

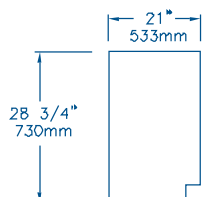

\* Legal or letter size file drawers with hanger bars and full extension slide arms.

\*\* Back panel is 9" in height (229 mm). Stainless steel waste chute and waste basket are available by adding "WVC" and "WB" to model number.

Reverse models are also available as a standard cabinet by adding "REV" to model number.

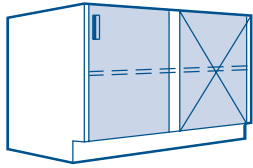

Model no.	Width	
	inches	mm
B20-30	30	762
B20-36	36	914
B20-42	42	1067
B20-48	48	1219

## Corner unit with 1 door (left)

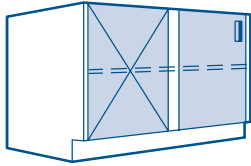

B21-30	30	762
B21-36	36	914
B21-42	42	1067
B21-48	48	1219

## Corner unit with 1 door (right)

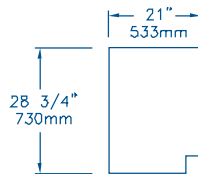
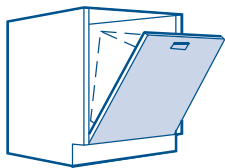

B28-18	18	457
B28-24	24	610

## Description

- Bins are not included.
- Bins can be supplied by adding the following letters after catalog number:
  - "GB" for galvanized steel;
  - "SSB" for stainless steel type 304;
  - For leak proof bin add the letters "LP".

## 1 door bin unit

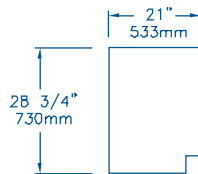
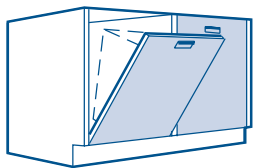

B29-36	36	914
B29-48	48	1219

- Bins are not included.
- Bins can be supplied by adding the following letters after catalog number:
  - "GB" for galvanized steel;
  - "SSB" for stainless steel type 304;
  - For leak proof bin add the letters "LP".

## 2 door bin unit

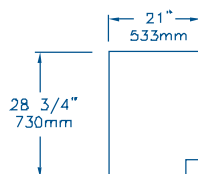
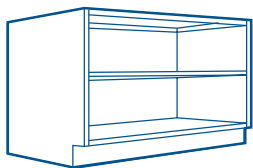

B35-15	15	381
B35-18	18	457
B35-21	21	533
B35-24	24	610
B35-30	30	762
B35-36	36	914
B35-42	42	1067
B35-48	48	1219

- One (1) adjustable shelf.

## Open rack unit

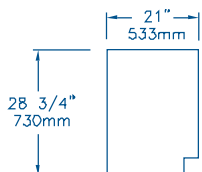

# Knee spaces, fillers, gables and tables

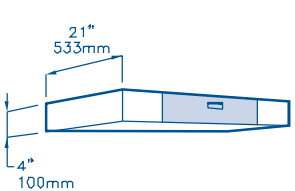

Model no.	Width	
	inches	mm
A46-24	24	610
A46-30	30	762
A46-36	36	914
A46-42	42	1067
A46-48	48	1219

## Knee space

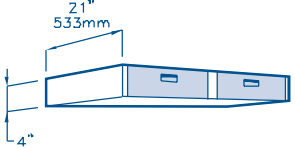

A47-36	36	914
A47-42	42	1067
A47-48	48	1219

## Knee space

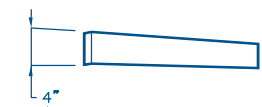

A48-24	24	610
A48-30	30	762
A48-36	36	914
A48-42	42	1067
A48-48	48	1219

## Knee space apron



A49-24	24	610
A49-30	30	762
A49-36	36	914
A49-42	42	1067
A49-48	48	1219

## Knee space and service cover panel\*

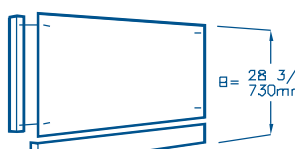

B49-24	24	610
B49-30	30	762
B49-36	36	914
B49-42	42	1067
B49-48	48	1219

## Knee space and service cover panel\*

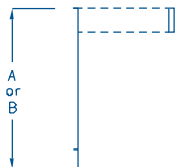

\* Provides easy access to pipe space in the back.

\*\* 2" x 2" (51 mm x 51 mm) steel tubing, cross brack and levellers.

\*\*\* Can be made to specification.

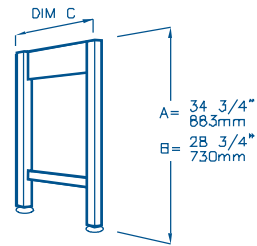

A50-22	22	559
A50-28	28	711
A50-34	34	864
A50-46	46	1168
B50-22	22	559
B50-28	28	711
B50-34	34	864
B50-46	46	1168

## Leg set\*\*

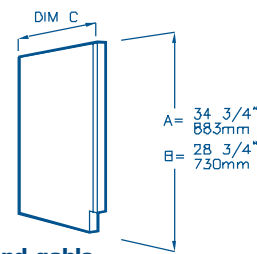

A51-21	21	533
A51-29	29	737
B51-21	21	533
B51-29	29	737

## End gable

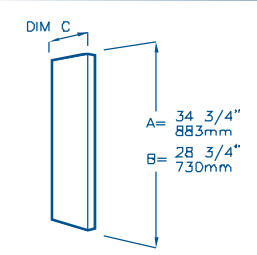

AEFP-2	2	51
AEFP-8	8	203
AEFP-10	10	254
AEFP-16	16	406
BEFP-2	2	51
BEFP-8	8	203
BEFP-10	10	254
BEFP-16	16	406

## End filler panel\*\*\*

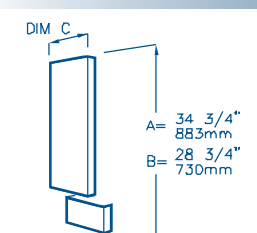

AFFP	As required
BFFP	As required

## Front filler panel\*\*\*

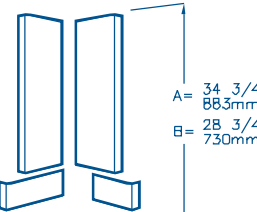

ACFP	As required
BCFP	As required

## Corner filler panel\*\*\*



## Knee spaces, fillers, gables and tables

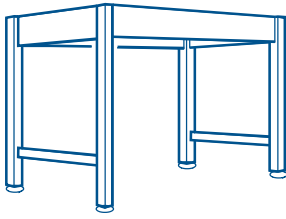

**Utility table**

Model no.	Width	
	inches	mm
A52-3422	34	864
A52-4622	46	1168
A52-5822	58	1473
A52-3428	34	864
A52-4628	46	1168
A52-5828	58	1473
B52-3422	34	864
B52-4622	46	1168
B52-5822	58	1473

### Description

- Special size tables are available on request.
- Double faced and multiple legs are available on request.
- Legs are 2" x 2" (51 x 51 mm) – 16 gauge steel tubing; aprons are 4" (100 mm) 18 gauge steel.
- Each leg is supplied with 2 adjustable levellers.
- Tables can be supplied with casters on request.
- Tables are shipped knock-down.

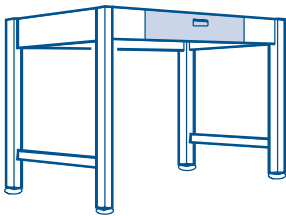

**Utility table with drawer**

A53-3422	34	864
A53-4622	46	1168
A53-5822	58	1473
A53-3428	34	864
A53-4628	46	1168
A53-5828	58	1473
B53-3422	34	864
B53-4622	46	1168
B53-5822	58	1473
B53-3428	34	864
B53-4628	46	1168
B53-5828	58	1473

- Special size tables are available on request.
- Double faced (minimum 42" – (1067 mm) and multiple legs are available on request.
- Extra drawers can be supplied by adding total number of drawers after catalog number.
- Legs are 2" x 2" (51 x 51 mm) – 16 gauge steel tubing; aprons are 4" (100 mm) 18 gauge steel.
- Each leg is supplied with 2 adjustable levellers.
- Tables can be supplied with casters on request.
- Tables are shipped knock-down.

## Wall cases

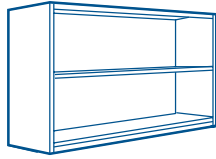

**Open shelf unit**

Model no.	Width	
	inches	mm
54-15-14	15	381
54-18-14	18	457
54-21-14	21	533
54-24-14	24	610
54-30-14	30	762
54-36-14	36	914
54-42-14	42	1067
54-48-14	48	1219
54-15-18	15	381
54-18-18	18	457
54-21-18	21	533
54-24-18	24	610
54-30-18	30	762
54-36-18	36	914
54-42-18	42	1067
54-48-18	48	1219

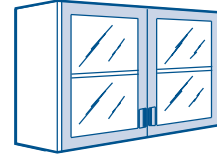

**2 glazed hinged doors**

58-30-14	30	762
58-36-14	36	914
58-42-14	42	1067
58-48-14	48	1219
58-30-18	30	762
58-36-18	36	914
58-42-18	42	1067
58-48-18	48	1219

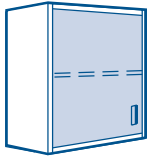

**1 solid hinged door**

55-15-14	15	381
55-18-14	18	457
55-21-14	21	533
55-24-14	24	610
55-15-18	15	381
55-18-18	18	457
55-21-18	21	533
55-24-18	24	610

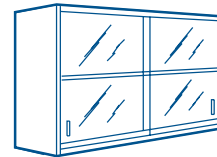

**2 glass sliding doors**

59-30-14	30	762
59-36-14	36	914
59-42-14	42	1067
59-48-14	48	1219
59-30-18	30	762
59-36-18	36	914
59-42-18	42	1067
59-48-18	48	1219

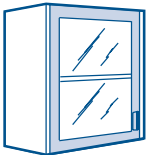

**1 glazed hinged door**

56-15-14	15	381
56-18-14	18	457
56-21-14	21	533
56-24-14	24	610
56-15-18	15	381
56-18-18	18	457
56-21-18	21	533
56-24-18	24	610

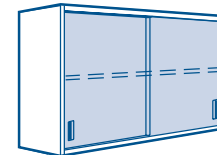

**2 solid sliding doors**

60-30-14	30	762
60-36-14	36	914
60-42-14	42	1067
60-48-14	48	1219
60-30-18	30	762
60-36-18	36	914
60-42-18	42	1067
60-48-18	48	1219

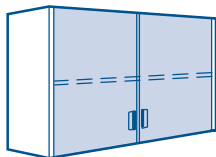

**2 solid hinged doors**

57-30-14	30	762
57-36-14	36	914
57-42-14	42	1067
57-48-14	48	1219
57-30-18	30	762
57-36-18	36	914
57-42-18	42	1067
57-48-18	48	1219

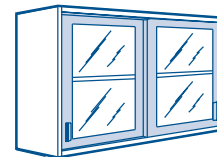

**2 glazed sliding doors**

61-30-14	30	762
61-36-14	36	914
61-42-14	42	1067
61-48-14	48	1219
61-30-18	30	762
61-36-18	36	914
61-42-18	42	1067
61-48-18	48	1219

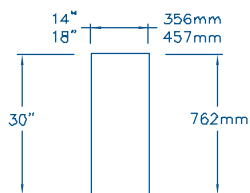

Reverse models are also available as a standard cabinet by adding "REV" to model number.

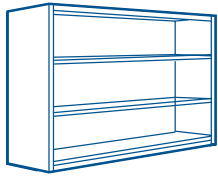

**Open shelf unit**

Model no.	Width	
	inches	mm
63-15-14	15	381
63-18-14	18	457
63-21-14	21	533
63-24-14	24	610
63-30-14	30	762
63-36-14	36	914
63-42-14	42	1067
63-48-14	48	1219
63-15-18	15	381
63-18-18	18	457
63-21-18	21	533
63-24-18	24	610
63-30-18	30	762
63-36-18	36	914
63-42-18	42	1067
63-48-18	48	1219

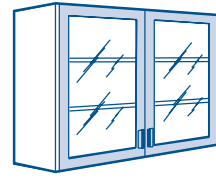

**2 glazed hinged doors**

67-30-14	30	762
67-36-14	36	914
67-42-14	42	1067
67-48-14	48	1219
67-30-18	30	762
67-36-18	36	914
67-42-18	42	1067
67-48-18	48	1219



**1 solid hinged door**

64-15-14	15	381
64-18-14	18	457
64-21-14	21	533
64-24-14	24	610
64-15-18	15	381
64-18-18	18	457
64-21-18	21	533
64-24-18	24	610

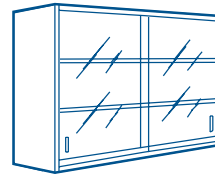

**2 glass sliding doors**

68-30-14	30	762
68-36-14	36	914
68-42-14	42	1067
68-48-14	48	1219
68-30-18	30	762
68-36-18	36	914
68-42-18	42	1067
68-48-18	48	1219



**1 glazed hinged door**

65-15-14	15	381
65-18-14	18	457
65-21-14	21	533
65-24-14	24	610
65-15-18	15	381
65-18-18	18	457
65-21-18	21	533
65-24-18	24	610

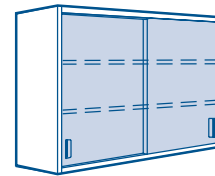

**2 solid sliding doors**

69-30-14	30	762
69-36-14	36	914
69-42-14	42	1067
69-48-14	48	1219
69-30-18	30	762
69-36-18	36	914
69-42-18	42	1067
69-48-18	48	1219

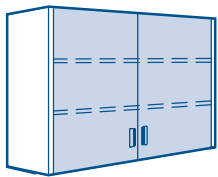

**2 solid hinged doors**

66-30-14	30	762
66-36-14	36	914
66-42-14	42	1067
66-48-14	48	1219
66-30-18	30	762
66-36-18	36	914
66-42-18	42	1067
66-48-18	48	1219

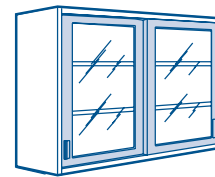

**2 glazed sliding doors**

70-30-14	30	762
70-36-14	36	914
70-42-14	42	1067
70-48-14	48	1219
70-30-18	30	762
70-36-18	36	914
70-42-18	42	1067
70-48-18	48	1219

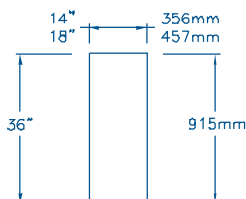

Reverse models are also available as a standard cabinet by adding "REV" to model number.

## Wall cases

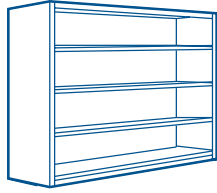

**Open shelf unit**

Model no.	Width	
	inches	mm
72-15-14	15	381
72-18-14	18	457
72-21-14	21	533
72-24-14	24	610
72-30-14	30	762
72-36-14	36	914
72-42-14	42	1067
72-48-14	48	1219
72-15-18	15	381
72-18-18	18	457
72-21-18	21	533
72-24-18	24	610
72-30-18	30	762
72-36-18	36	914
72-42-18	42	1067
72-48-18	48	1219

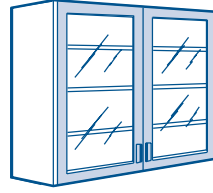

**2 glazed hinged doors**

76-30-14	30	762
76-36-14	36	914
76-42-14	42	1067
76-48-14	48	1219
76-30-18	30	762
76-36-18	36	914
76-42-18	42	1067
76-48-18	48	1219

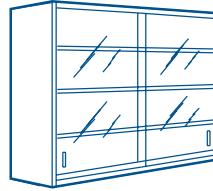

**2 glass sliding doors**

77-30-14	30	762
77-36-14	36	914
77-42-14	42	1067
77-48-14	48	1219
77-30-18	30	762
77-36-18	36	914
77-42-18	42	1067
77-48-18	48	1219

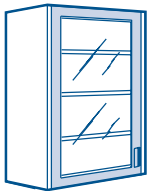

**1 glazed hinged door**

73-15-14	15	381
73-18-14	18	457
73-21-14	21	533
73-24-14	24	610
73-15-18	15	381
73-18-18	18	457
73-21-18	21	533
73-24-18	24	610

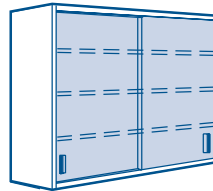

**2 solid sliding doors**

78-30-14	30	762
78-36-14	36	914
78-42-14	42	1067
78-48-14	48	1219
78-30-18	30	762
78-36-18	36	914
78-42-18	42	1067
78-48-18	48	1219

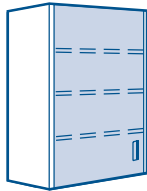

**1 solid hinged door**

74-15-14	15	381
74-18-14	18	457
74-21-14	21	533
74-24-14	24	610
74-15-18	15	381
74-18-18	18	457
74-21-18	21	533
74-24-18	24	610

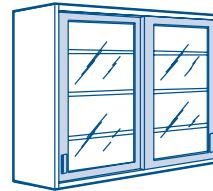

**2 glazed sliding doors**

79-30-14	30	762
79-36-14	36	914
79-42-14	42	1067
79-48-14	48	1219
79-30-18	30	762
79-36-18	36	914
79-42-18	42	1067
79-48-18	48	1219

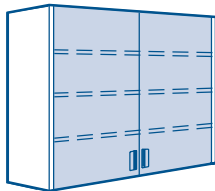

**2 solid hinged doors**

75-30-14	30	762
75-36-14	36	914
75-42-14	42	1067
75-48-14	48	1219
75-30-18	30	762
75-36-18	36	914
75-42-18	42	1067
75-48-18	48	1219

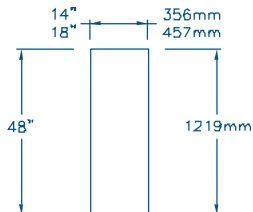

Reverse models are also available as a standard cabinet by adding "REV" to model number.

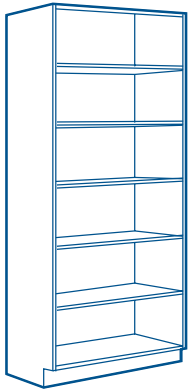

**Open shelf unit**

Model no.	Width	
	inches	mm
85-15-14	15	381
85-18-14	18	457
85-21-14	21	533
85-24-14	24	610
85-30-14	30	762
85-36-14	36	914
85-42-14	42	1067
85-48-14	48	1219
85-15-18	15	381
85-18-18	18	457
85-21-18	21	533
85-24-18	24	610
85-30-18	30	762
85-36-18	36	914
85-42-18	42	1067
85-48-18	48	1219
85-15-22	15	381
85-18-22	18	457
85-21-22	21	533
85-24-22	24	610
85-30-22	30	762
85-36-22	36	914
85-42-22	42	1067
85-48-22	48	1219

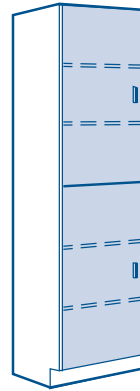

**2 solid hinged doors**

86A-15-14	15	381
86A-18-14	18	457
86A-21-14	21	533
86A-24-14	24	610
86A-15-18	15	381
86A-18-18	18	457
86A-21-18	21	533
86A-24-18	24	610
86A-15-22	15	381
86A-18-22	18	457
86A-21-22	21	533
86A-24-22	24	610



**1 solid hinged door**

86-15-14	15	381
86-18-14	18	457
86-21-14	21	533
86-24-14	24	610
86-15-18	15	381
86-18-18	18	457
86-21-18	21	533
86-24-18	24	610
86-15-22	15	381
86-18-22	18	457
86-21-22	21	533
86-24-22	24	610

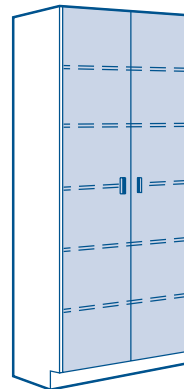

**2 solid hinged doors**

86-30-14	30	762
86-36-14	36	914
86-42-14	42	1067
86-48-14	48	1219
86-30-18	30	762
86-36-18	36	914
86-42-18	42	1067
86-48-18	48	1219
86-30-22	30	762
86-36-22	36	914
86-42-22	42	1067
86-48-22	48	1219

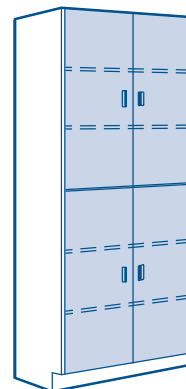
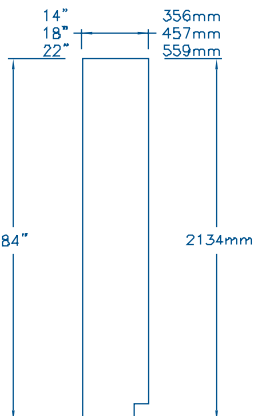

**4 solid hinged doors**

86A-30-14	30	762
86A-36-14	36	914
86A-42-14	42	1067
86A-48-14	48	1219
86A-30-18	30	762
86A-36-18	36	914
86A-42-18	42	1067
86A-48-18	48	1219
86A-30-22	30	762
86A-36-22	36	914
86A-42-22	42	1067
86A-48-22	48	1219

Reverse models are also available as a standard cabinet by adding "REV" to model number.

# Floor cases



Model no.	Width	
	inches	mm
87-15-14	15	381
87-18-14	18	457
87-21-14	21	533
87-24-14	24	610
87-15-18	15	381
87-18-18	18	457
87-21-18	21	533
87-24-18	24	610
87-15-22	15	381
87-18-22	18	457
87-21-22	21	533
87-24-22	24	610

**1 glazed hinged door**

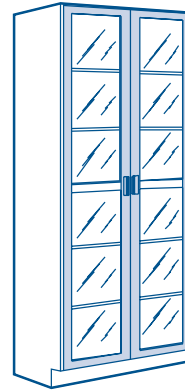

87-30-14	30	762
87-36-14	36	914
87-42-14	42	1067
87-48-14	48	1219
87-30-18	30	762
87-36-18	36	914
87-42-18	42	1067
87-48-18	48	1219
87-30-22	30	762
87-36-22	36	914
87-42-22	42	1067
87-48-22	48	1219

**2 glazed hinged doors**

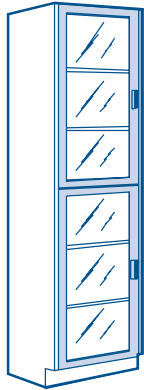

87A-15-14	15	381
87A-18-14	18	457
87A-21-14	21	533
87A-24-14	24	610
87A-15-18	15	381
87A-18-18	18	457
87A-21-18	21	533
87A-24-18	24	610
87A-15-22	15	381
87A-18-22	18	457
87A-21-22	21	533
87A-24-22	24	610

**2 glazed hinged doors**

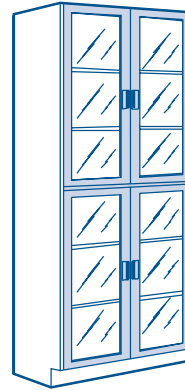

87A-30-14	30	762
87A-36-14	36	914
87A-42-14	42	1067
87A-48-14	48	1219
87A-30-18	30	762
87A-36-18	36	914
87A-42-18	42	1067
87A-48-18	48	1219
87A-30-22	30	762
87A-36-22	36	914
87A-42-22	42	1067
87A-48-22	48	1219

**4 glazed hinged doors**

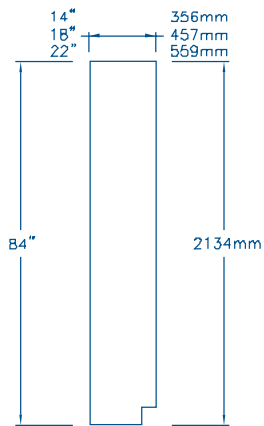

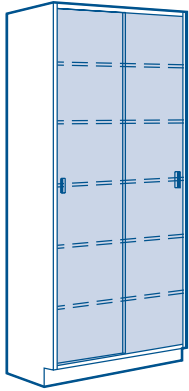

Model no.	Width	
	inches	mm
88-30-14	30	762
88-36-14	36	914
88-42-14	42	1067
88-48-14	48	1219
88-30-18	30	762
88-36-18	36	914
88-42-18	42	1067
88-48-18	48	1219
88-30-22	30	762
88-36-22	36	914
88-42-22	42	1067
88-48-22	48	1219

**2 solid sliding doors**

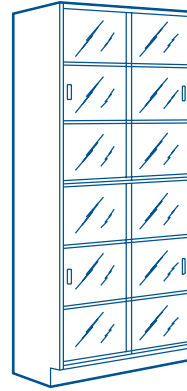

89-30-14	30	762
89-36-14	36	914
89-42-14	42	1067
89-48-14	48	1219
89-30-18	30	762
89-36-18	36	914
89-42-18	42	1067
89-48-18	48	1219
89-30-22	30	762
89-36-22	36	914
89-42-22	42	1067
89-48-22	48	1219

**4 glass sliding doors**

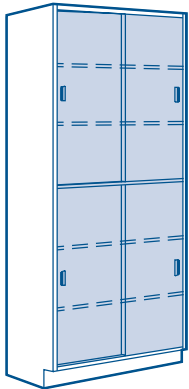

88A-30-14	30	762
88A-36-14	36	914
88A-42-14	42	1067
88A-48-14	48	1219
88A-30-18	30	762
88A-36-18	36	914
88A-42-18	42	1067
88A-48-18	48	1219
88A-30-22	30	762
88A-36-22	36	914
88A-42-22	42	1067
88A-48-22	48	1219

**4 solid sliding doors**

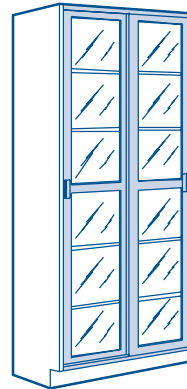

90-30-14	30	762
90-36-14	36	914
90-42-14	42	1067
90-48-14	48	1219
90-30-18	30	762
90-36-18	36	914
90-42-18	42	1067
90-48-18	48	1219
90-30-22	30	762
90-36-22	36	914
90-42-22	42	1067
90-48-22	48	1219

**2 glazed sliding doors**

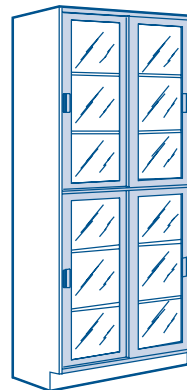
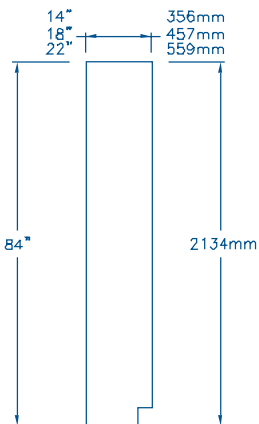

90A-30-14	30	762
90A-36-14	36	914
90A-42-14	42	1067
90A-48-14	48	1219
90A-30-18	30	762
90A-36-18	36	914
90A-42-18	42	1067
90A-48-18	48	1219
90A-30-22	30	762
90A-36-22	36	914
90A-42-22	42	1067
90A-48-22	48	1219

**4 glazed sliding doors**

**(bedcolab)**

**Bedcolab Ltd**  
**2305, Francis-Hugues Avenue**  
**Laval, Quebec, Canada H7S 1N5**  
**Phone: 514.384.2820 / 1.800.461.6414**  
**Fax: 514.384.9210**  
**E-mail: info@bedcolab.com**  
**Web Site: www.bedcolab.com**

**SINCE/DEPUIS**  
**1976**



**Authorized dealer:**